

냉간 단조 제품 소재 크랙 방지를
위한 공정 변경

발레오만도(주)

강종훈, 박선평

냉간 단조 제품의 크랙방지를 위한 공정변경

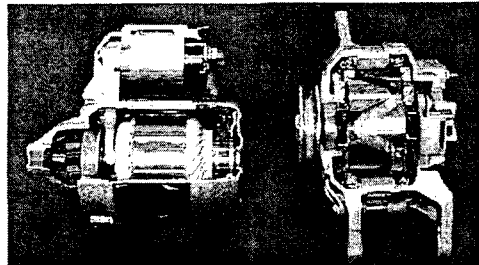

강종훈, 박선평

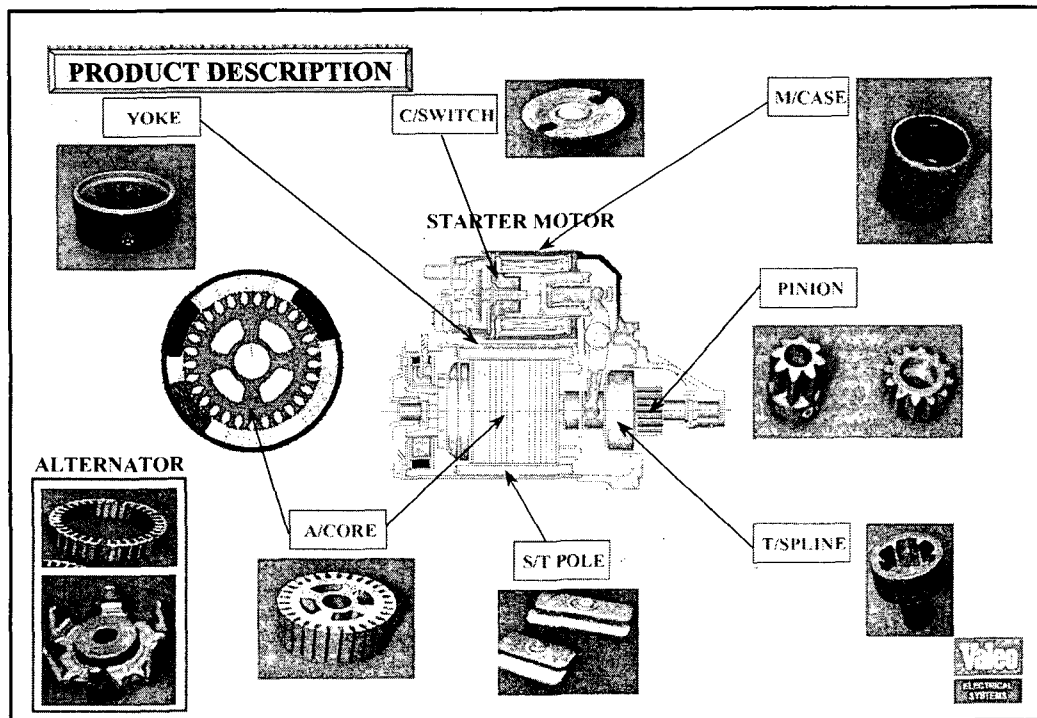

PRODUCT 1

- METAL FORMING PRODUCTS -

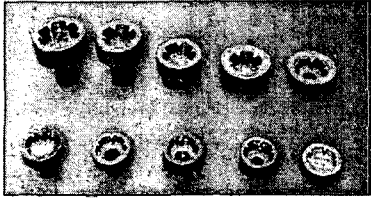

THRUST SPLINE

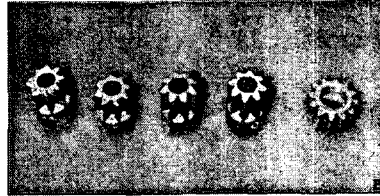

PINION GEAR

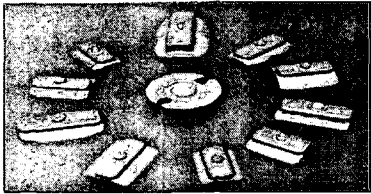

POLE & C/S SWITCH

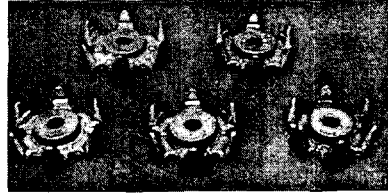

2PCS ROTOR POLE



PRODUCT 2

- SHEET METAL PRODUCTS -

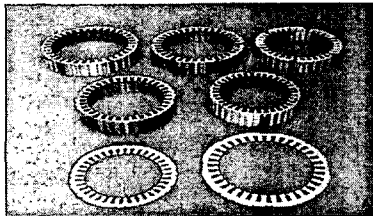

STATOR CORE

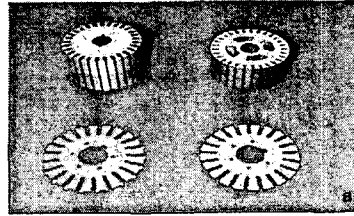

ARMATURE CORE

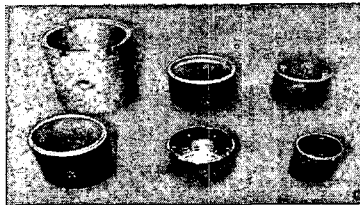

YOKE & M/CASE



LINE DESCRIPTION

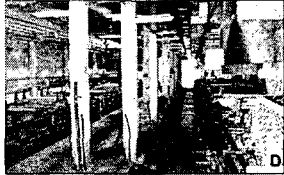
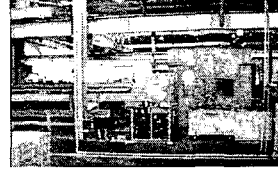
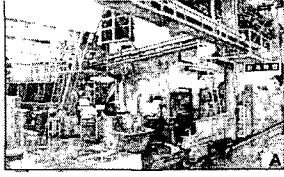

- A. FORGING PRESS AND TRANSFER
- B. ANNEALING FURNACE LINE
- C. CUTTING M/C
- D. PHOSPATE LINE
- E. SLINKY CORE LINE & HIGH SPEED PRESS
- F. ROBOTIC MACHINE LINE
- G. AUTOMATIC PAINTING LINE



NEW DEVELOPMENT

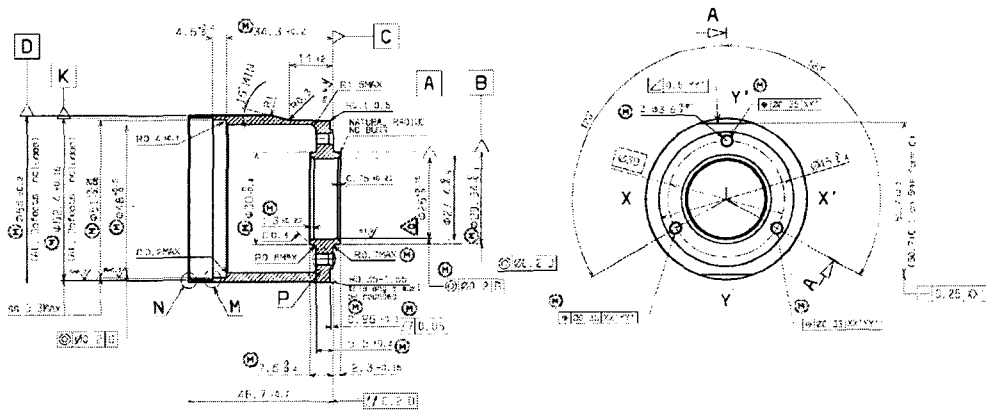

- 1) STARTER MOTOR용 MAGNETIC CASE
- 2) 재질 : S10C상당
- 3) 수량 : 130,000 pcs/month



Forging Process

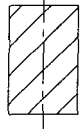

Annealing
Shot Blast
Phosphating

cutting

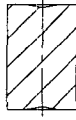

upsetting



upsetting

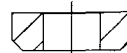

Piercing

630ton Schuler Press

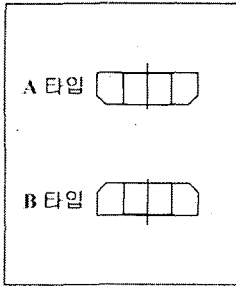

A 타입

B 타입

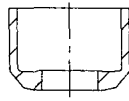

B.W.Ext.

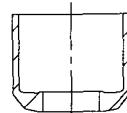

Ironing

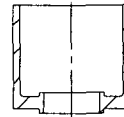

Sizing

630ton Schuler Press



Product & Problem

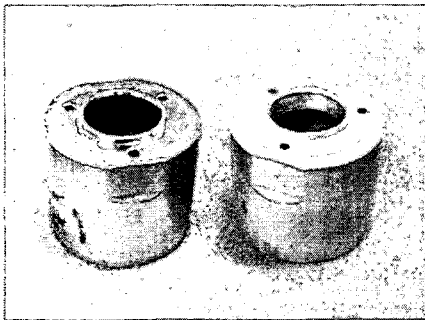

완성 제품



크랙 발생품

크랙 발생률 : 80%



F.E.M Analysis

A TYPE

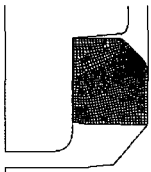

Damage

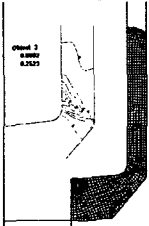

B TYPE

